

Disc Check Valve

Fig.622 : Wafer

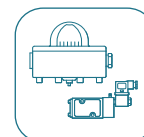

www.coreline.dk

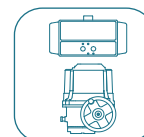
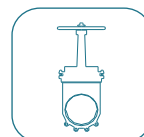
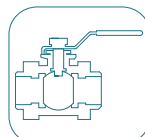
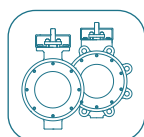
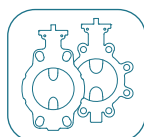

General information

Connection:	Wafer
Nominal diameter:	DN15-DN100
Rating:	CLASS150/CLASS300, PN10/PN16/PN25/40
Face to face:	DIN3202-K4
Body:	CF8M, CF8
Disc:	CF8M, CF8
Segment:	SS316, SS304
Spring:	SS316, SS304

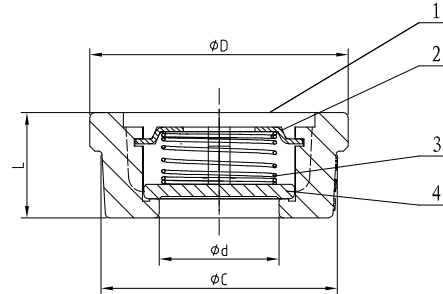
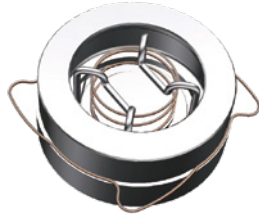

Material part list

No.	Part name	Material	Quantity
1	Body	CF8M, CF8	1
2	Segment	SS316, SS304	1
3	Spring	SS316, SS304	1
4	Disc	CF8M, CF8	1

Dimensions

DN	INCH	D	d	C	L
15	1/2"	39	15	34	16
20	3/4"	46	20	40	19
25	1"	54	35	50	22
32	1 1/4"	70	32	62	28
40	1 1/2"	80	40	70	32
50	2"	94	46	85	40
65	1 1/2"	112	62	100	46
80	3"	132	75	120	50
100	4"	150	86	140	60

Technical data

DN	INCH	Opening pressure [mbar]	Kv [$\Delta P=0.1\text{bar}$]
15	1/2"	39	15
20	3/4"	46	20
25	1"	54	35
32	1 1/4"	70	32
40	1 1/2"	80	40
50	2"	94	46
65	1 1/2"	112	62
80	3"	132	75
100	4"	150	86

Coreline

The contents of this catalogue are confidential and proprietary to Coreline, we reserve the right to change the specifications without any notice.

CORELINE LTD.

Add: No.4 Wangjiang Road, Muqiao Town, Zhengpugang New District, 238200 Hexian, Ma'anshan City, Anhui Province, China

Http: // www.coreline.dk

E-mail: mail@coreline.cn